

F360 Dust Collector

Features & Benefits



- **Capacities to 9000 CFM:**
Handles toughest industrial applications.
- **Class II Belt-Drive Blower:**
Higher static pressure, longer filter life and greater reliability; non-sparking; no belts or pulleys to replace.
- **Non-electrostatic operation:**
High reliability, low maintenance.
- **Ultra-Seal® filter mounting:**
Eliminates contaminant bypass of filters.
- **High efficiency filter media:**
Provides maximum effectiveness; low air-to-cloth ratio extends cycles between filter changes; filter changes easily without tools.
- **Prewired to junction box:**
For fast, easy installation.

Dimensions

Width:	72.00"
Height:	32.00"
Depth:	70.00"

Options

- **Pressure Gauge Kit:**
Indicates when filters require cleaning.
- **Silencer:**
Reduces air flow noise for quieter operation.
- **Charcoal Adsorber Modules:**
Refillable modules control gases and odors.
- **HEPA After-Filter:**
provides 99.97% DOP efficiency.
- **Inlet Plenum**
- **Floor Stand:**
Allows on-floor mounting when on-machine or hanging mounts are impractical.

Specifications

- **Construction:**
16 ga. steel cabinet, powder coated
- **Blower Pkg (HP):**
10.0
- **Noise Level (dBA):**
86/80 silencer
- **Electrical:**
10.0 HP - 208-230/460/3/60, 28.4/14.2
10.0 HP - 190/380/3/50, 26/13
- **Nominal CFM (in.):**
6000-9000
- **Weight (lbs.):**
930

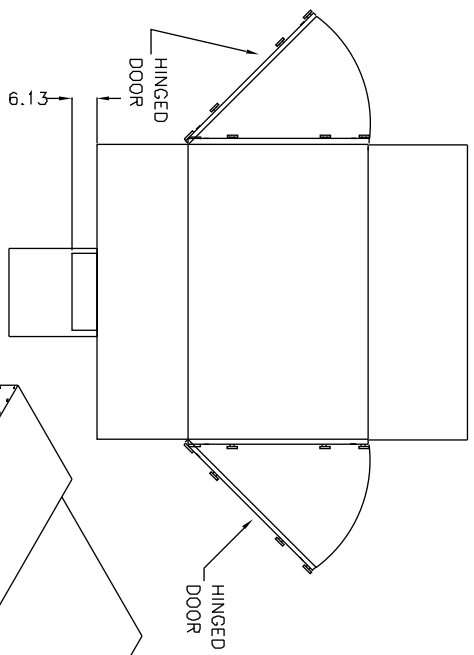

TOP VIEW

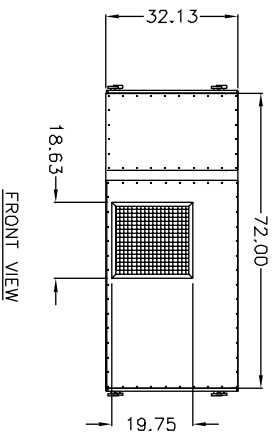

FRONT VIEW

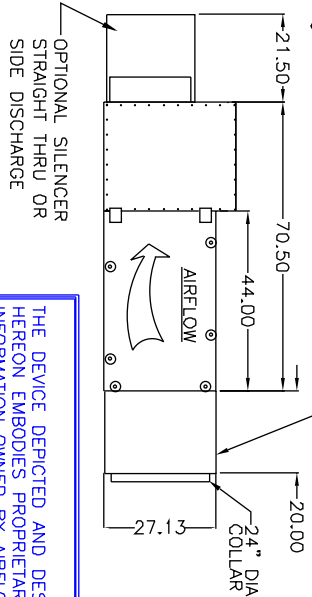
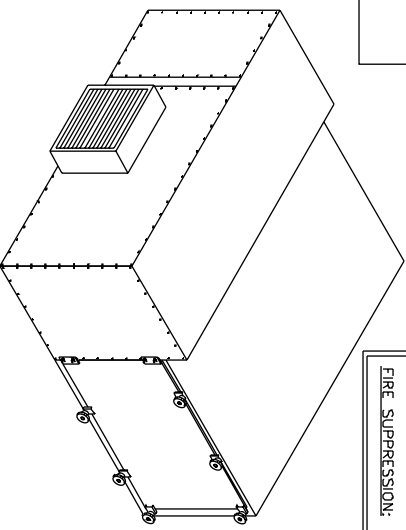

SIDE VIEW

CONSTRUCTION:

16 Gauge painted steel cabinet with Ultra-Seal™ filter sealing system, dual side access doors to filters, and a 1410 rpm belt driven, ball bearing, Class II blower with 4-way adjustable orifice blade exhaust grille. Motor wired to junction box out-side unit. Motor starters/disconnects not included, 932 lbs.

WEIGHT:

932 lbs.

AIRFLOW:

6000 CFM w/HEPA
10 HP 208-230/460/3/60, 28.5-28.4/14.2 amps

ELECTRICAL:

86 dBA / 80 dBA with silencer

NOISE:

FILTER SEAL:

Ultra-Seal™ welded picture frame with positive sealing filter locking mechanism for all main filters, HEPA filter and odorizer modules (when used). Slide in tracks shall be used for prefilters only

FIRE SUPPRESSION:

Equipment provided by others.

SPECIFICATIONS:

PREFILTERS:

- (3) 4" Pleat, 30%, std.
- (3) Aluminum mesh, opt.
- (3) 2" polyester, opt.
- (3) Chevron® filter, opt.

MAIN FILTERS:

- (3) 120 ft² multi-pocket 65%, std.
- (3) 95% - opt.
- (3) Easy clean, opt.

AFTER FILTERS:

- (3) 4" pleat prefilters, followed by (3) 66 ft², 95% bag filters and (3) 39.97% HEPA filters.
- (3) 95% D.O.P., HEPA, opt.

AD. OPTION:

- (3) 4" pleat prefilters followed by (3) 66 ft², 95% bag filters, (6) refillable AD modules, 25 lb. capacity each, and (3) 2" pleat afterfilters.

OTHER OPTIONS:

- Pressure gauge kit indicates filter changes
- Source capture plenum
- Dots, 3/4" NPT
- Silencer
- 1650 rpm Blower - High static
- 1725 rpm Blower - High static

* AHS FILTER EFFICIENCIES BASED ON ASHRAE 52-76 TEST METHOD

PERFORMANCE CURVES

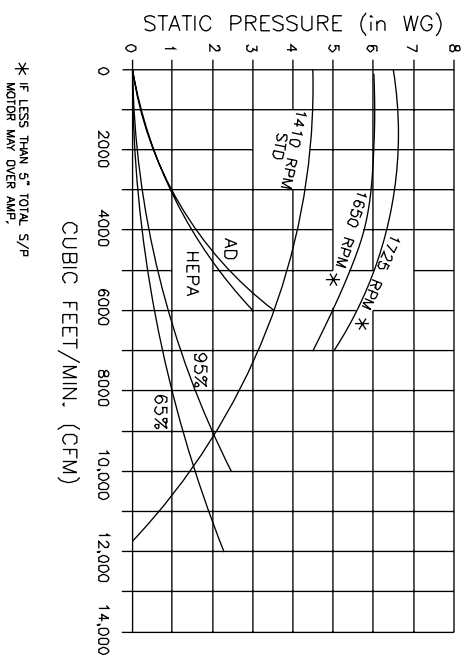

* IF LESS THAN 5" TOTAL S/P MOTOR MAY OVER AMP.

NOTES:

See page 2 for hole pattern for optional s/c plenum. Items designated as are included in this proposal.

THE DEVICE DEPICTED AND DESCRIBED HEREOF EMBODIES PROPRIETARY INFORMATION OWNED BY AIRFLOW SYSTEMS, INC. ALL DESIGN, MANUFACTURING, REPRODUCTION, SALES, AND PATENT RIGHTS REGARDING THIS DEVICE OR DRAWING ARE RESERVED EXCEPT WHERE EXPLICIT RIGHT IS GRANTED IN WRITING.

Diversified Air Systems, Inc.
Phone: 800-264-8958

DRAWN BY CB	TITLE MODEL F360
DATE 5-9-00	PAGE 1 OF 2
SCALE	DRAWING NO.: F360SPC (36-2657/J)

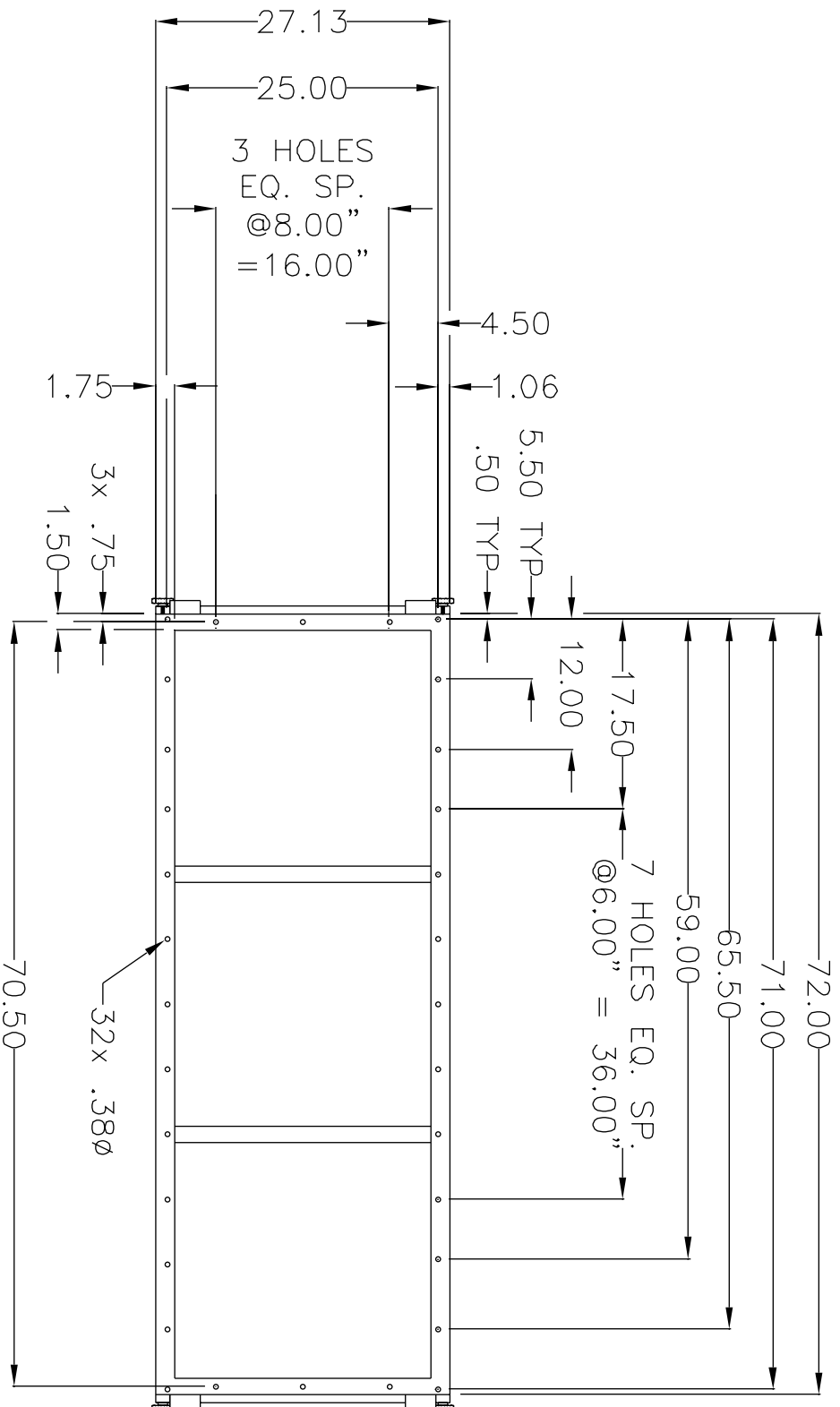

INLET VIEW

NOTES:

Hole pattern is symmetrical top to bottom.

THE DEVICE DEPICTED AND DESCRIBED
 HEREON EMBODIES PROPRIETARY
 INFORMATION OWNED BY AIRFLOW SYSTEMS,
 INC. ALL DESIGN, MANUFACTURING,
 REPRODUCING, SALES, AND PATENT RIGHTS
 REGARDING THIS DEVICE OR DRAWING ARE
 RESERVED EXCEPT WHERE EXPLICIT RIGHT
 IS GRANTED IN WRITING.

Diversified Air Systems, Inc.
 Phone: 800-264-8958

DRAWN BY CB	TITLE MODEL F360
DATE 5-9-00	PAGE 2 OF 2
SCALE	DRAWING NO. F-360SPC (36-2657/J)

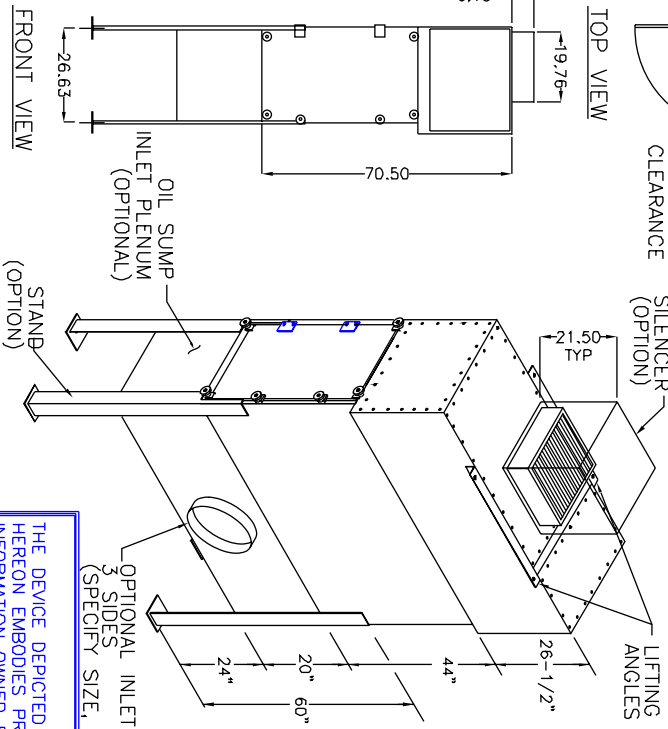
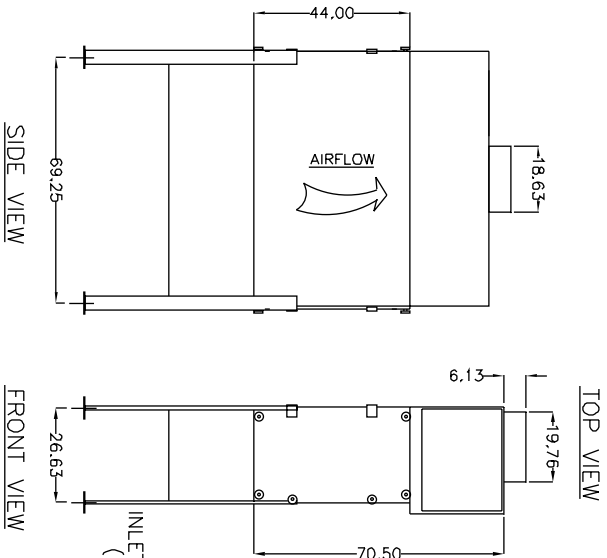
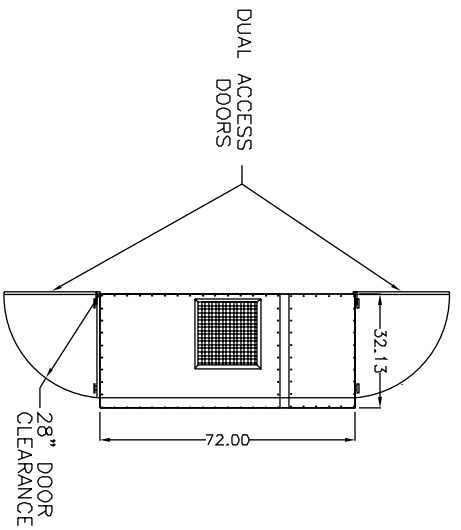

SPECIFICATIONS:

- CONSTRUCTION:**
16 Gauge painted steel cabinet with Ultra-Seal® filter sealing system, dual side access doors to filters, and a 1410 rpm belt driven, ball bearing, Class II blower with 4-way adjustable air/fall blade exhaust grille. Motor wired to junction box outside unit. Motor starters/disconnects not included.
- WEIGHT:**
1030 lbs.
- AIRFLOW:**
9000 CFM
8000 CFM w/HEPA
- ELECTRICAL:**
10 HP 208-230/460/3/60, 28.5-28.4/14.2 amps
- NOISE:**
86 dBA / 80 dBA with silencer
- FILTER SEAL:**
Ultra-Seal® welded picture frame with positive sealing filter locking mechanism for all main filters. HEPA filter and adsorbent modules (when used). Slide in tracks shall be used for prefilters only.
- FIRE SUPPRESSION:** Equipment provided by others.

PERFORMANCE CURVES

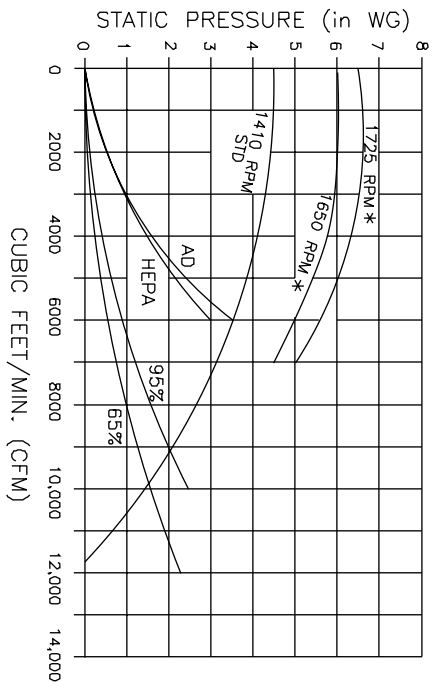

* IF LESS THAN 5" TOTAL S/P MOTOR MAY OVER AMP.

- PREFILTERS:**
 (3) 4" Pleat, 30%, std.
 (3) Aluminum mesh, opt.
 (3) 2" polyester, opt.
 (3) Chevron® filter, opt.
- MAIN FILTERS:**
 (3) 120 ft² multi-pocket 65%, std.
 (3) 95% - opt.
 (3) Easy clean, opt.
- AFTER FILTERS:**
 (3) 4" pleat prefilters followed by (3) 66 ft², 95% bag filters and (3) 99.97% HEPA filters.
 (3) 4" pleat prefilters followed by (3) 66 ft², 95% bag filters and (3) 99.97% HEPA filters.
- AD OPTION:**
 (3) 4" pleat prefilters followed by (3) 66 ft², 95% bag filters, (6) refillable AD modules, 25 lb. capacity each, and (3) 2" pleat afterfilters.
- OTHER OPTIONS:**
 Pressure gauge kit indicates filter changes
 Source capture plenum
 Drains, 3/4" NPT
 Silencer
 1650 rpm Blower - High static
 1725 rpm Blower - High static
- * AFS FILTER EFFICIENCIES BASED ON ASHRAE 52-76 TEST METHOD

NOTES:

See page 2 for hole pattern for optional s/c plenum. Items designated as are included in this proposal.

THE DEVICE DEPICTED AND DESCRIBED HEREON EMBODIES PROPRIETARY INFORMATION OWNED BY AIRFLOW SYSTEMS, INC. ALL DESIGN, MANUFACTURING, REPRODUCTION, SALES, AND PATENT RIGHTS REGARDING THIS DEVICE OR DRAWING ARE RESERVED EXCEPT WHERE EXPLICIT RIGHT IS GRANTED IN WRITING.

Diversified Air Systems, Inc.
Phone: 800-264-8958

DRAWN BY: JRS
 DATE: 3-8-01
 SCALE:
 TITLE: MODEL F360 VERTICAL
 PAGE 1 OF 2
 DRAWING NO.: F360VSPC (36-8083/K)

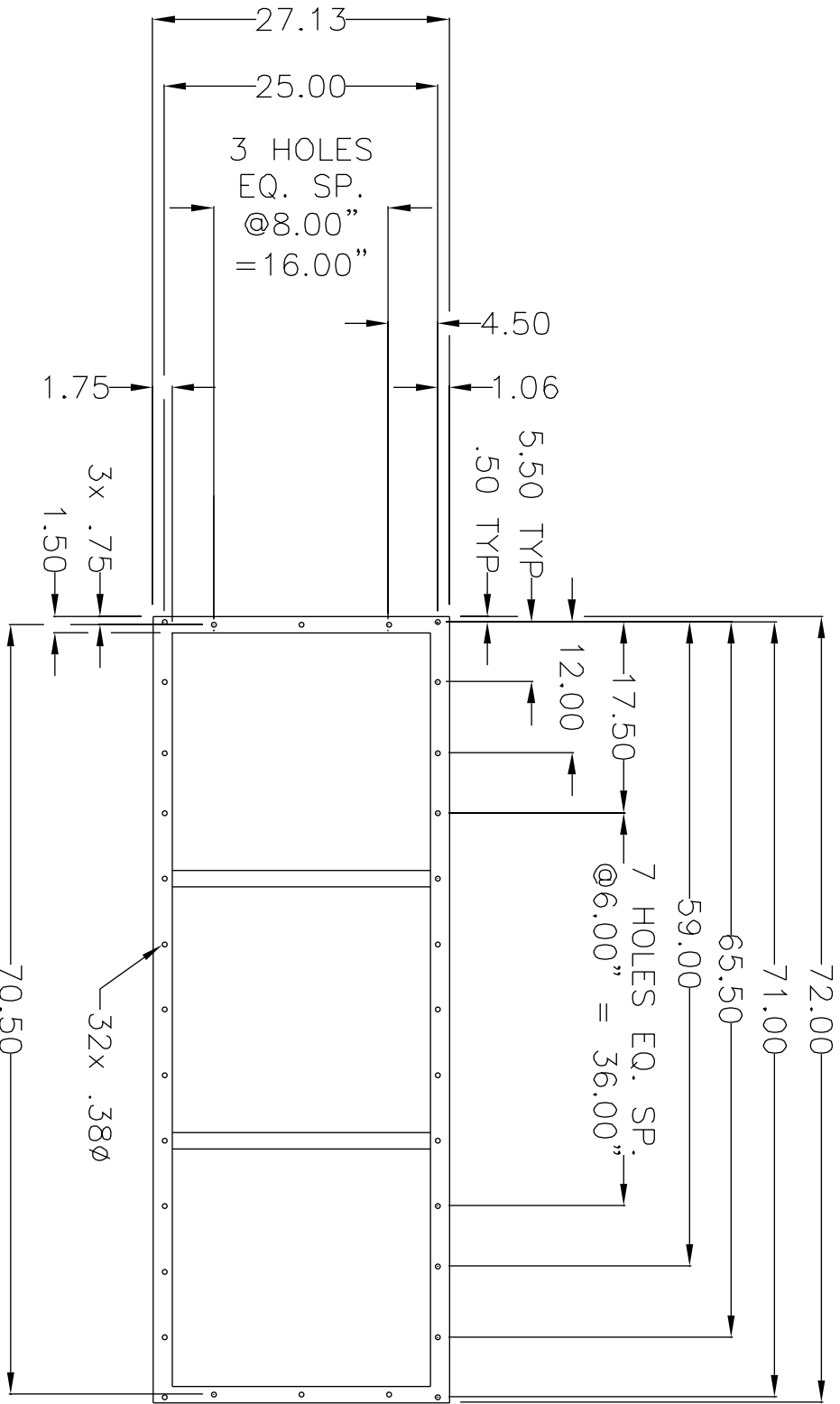

INLET VIEW

NOTES:

Hole pattern is symmetrical top to bottom.

THE DEVICE DEPICTED AND DESCRIBED
HEREON EMBODIES PROPRIETARY
INFORMATION OWNED BY AIRFLOW SYSTEMS,
INC. ALL DESIGN, MANUFACTURING,
REPRODUCTION, SALES, AND PATENT RIGHTS
REGARDING THIS DEVICE OR DRAWING ARE
RESERVED EXCEPT WHERE EXPLICIT RIGHT
IS GRANTED IN WRITING.

Diversified Air Systems, Inc.
Phone: 800-264-8958

DRAWN BY
JRS
DATE 3-8-01
SCALE

TITLE
MODEL F360 VERTICAL
PAGE 2 OF 2
DRAWING NO.: F360VSPC (36-3083/K)