

# PCH-1 Portable Dust Collector



## Features & Benefits

---

- **Complete, self-contained unit:**  
Includes 7-ft. E-Z Arm® High Flow Extractor Arm, blower, and filter cartridge.
- **Direct-drive blower:**  
Higher static pressure, longer filter life and greater reliability; non-sparking; no belts or pulleys to replace.
- **Non-electrostatic operation:**  
High reliability, low maintenance.
- **Ultra-Seal® filter mounting:**  
Eliminates contaminant bypass of filters.
- **Vibra-Pulse® Filter Cleaning System:**  
Cleans filters 75% more effectively than reverse pulse systems.
- **Low profile cabinet:**  
Low center of gravity for easy maneuverability and arm positioning.
- **Heavy-Duty, 25-ft. power cord:**  
Maximizes system portability and positioning during operation.

## Dimensions

---

Width:	24.00"
Height:	31.00"
Length:	37.00"

## Options

---

- **Pressure Gauge Kit:**  
Indicates when filters require cleaning.
- **10-ft. E-Z Arm® High Flow Extractor Arm:**  
Replaces standard 7-ft. E-Z Arm® for additional reach and peak system performance.
- **Cartridge Media:**  
Available for specific applications.
- **After-Filters:**  
99.97% HEPA, 95% DOP and odor modules.
- **65-Watt Halogen Light Kit:**  
Improves worker visibility.

## Specifications

---

- **Construction:**  
12/14/16 ga. welded steel, powder coated cabinet
- **Blower Pkgs (HP):**  
1.0, 1.5
- **Noise Level (dBA):**  
74
- **Electrical:**  
1.0 HP - 115/1/60, 12 amps, std.,  
1.5 HP - 115/208-230/1/60, 15/7.9-7.5/2.3 amps, opt.
- **Nominal CFM (in.):**  
600/800, 1.0/1.5 HP, 60 Hz  
600, 50 Hz
- **Weight (lbs.):**  
254

**SPECIFICATIONS:**

**CONSTRUCTION:**

12/14/16 Gauge steel cabinet finished with Powder-Coat Finish. Includes a 5 gallon external dust drawer, 7' E-Z ARM<sup>®</sup> High Flow Extractor arm, removable end cap for easy access to filter, removable panel for easy access to direct drive motor/blower, 8" casters, 25' 12 Ga. power cord, and on-off switch. Motor wired to junction box outside unit for 3 phase. Acoustical lining standard in blower compartment. Vibra-Pulse<sup>®</sup> cleaning standard.

**MAIN FILTERS:**

- (1) CLEAN-2<sup>®</sup> Filter cartridge, 16"Dx12", Std.
- (1) Cartridge, FIBERDUST<sup>®</sup>, Opt.
- (1) Cartridge, Spark Resistant, Opt.
- (1) Cartridge, Sunbond - H<sub>2</sub>O, Opt.
- (1) Cartridge, CleanPlus double treated fire retardant, Opt.

**AFTER FILTERS:**

- (1) External HEPA filter, 99.97%
- (1) External DOP filter, 95%
- (1) External adsorber, 25 lb. capacity
- (1) Activated Charcoal
- (1) Purfill

**OTHER OPTIONS:**

- Pressure gauge kit indicates filter changes
- 10' E-Z ARM<sup>®</sup> High Flow Extractor
- Regulator
- Silencer (Adds 3" to depth of unit)

\* AFS FILTER EFFICIENCIES BASED ON ASHRAE 52-76 TEST METHOD

**ELECTRICAL:**

- 1 HP 115 /1/60, 12 amps, std.
- 1.5 HP 115/208-230/1/60, 15/7.9-7.5 amps, opt
- 1.5 HP 208-230/460 /3/60, 4.9-4.6/2.3 amps, opt

**NOISE:**

- 254 lbs.
- 600 CFM with std. 1 HP motor
- 800 CFM with opt. 1.5 HP motor
- 74 dBA

**FIRE SUPPRESSION:** Equipment provided by others.

**SPECIAL NOTES:**

Compressed air filter provided by others.

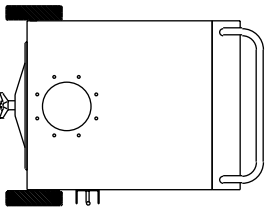

TOP VIEW  
(SHOWN LESS ARM)

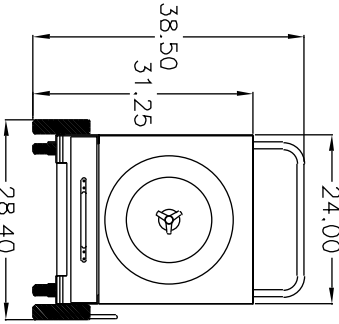

BACK VIEW  
(SHOWN LESS ARM)

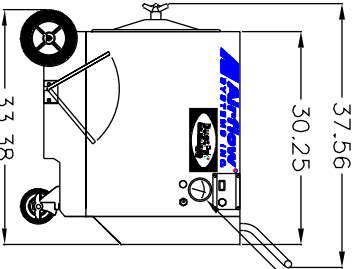

SIDE VIEW  
(SHOWN LESS ARM)

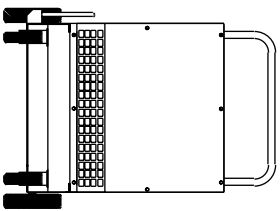

FRONT VIEW  
(SHOWN LESS ARM)

OPTIONAL  
PRESSURE  
GAUGE  
SHOWN

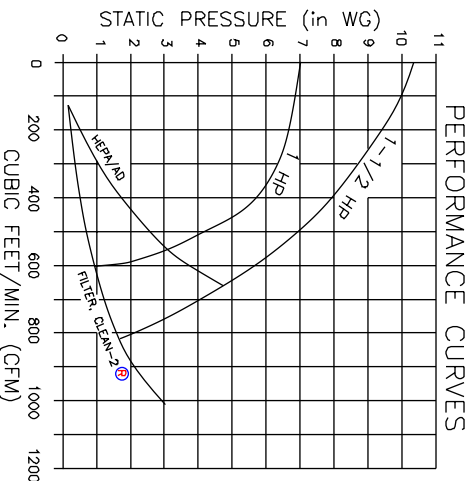
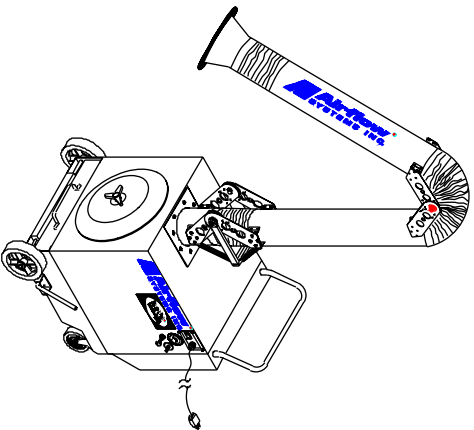

**NOTES:**

Items designated as  are included in this proposal.

THE DEVICE DEPICTED AND DESCRIBED HEREON EMBODIES PROPRIETARY INFORMATION OWNED BY AIRFLOW SYSTEMS, INC. ALL DESIGN, MANUFACTURING, REPRODUCTION, SALES, AND PATENT RIGHTS REGARDING THIS DEVICE OR DRAWING ARE RESERVED EXCEPT WHERE EXPLICIT RIGHT IS GRANTED IN WRITING.

**Diversified Air Systems, Inc.**  
Phone: 800-264-8958

DRAWN BY: CB  
DATE: 10-6-00  
SCALE:

TITLE: MODEL PCH1 (CARTRIDGE)  
PAGE 1 OF 2  
DRAWING NO.: PCH1SPEC (51-2877/C)

EXTERNAL  
HEPA/AD/DOP OPTION

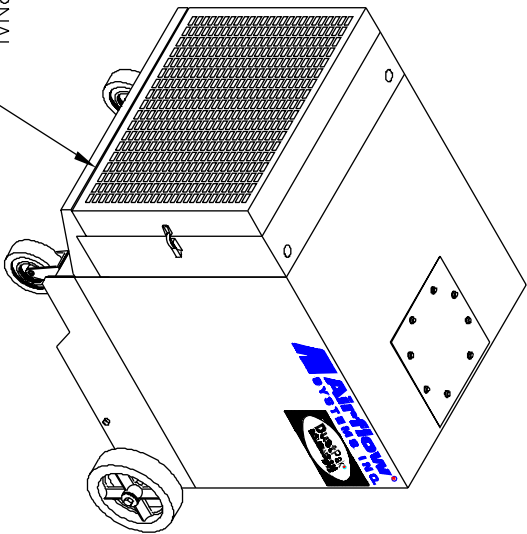

DUAL 4" X 8FT. E-Z ARM™  
OPTION

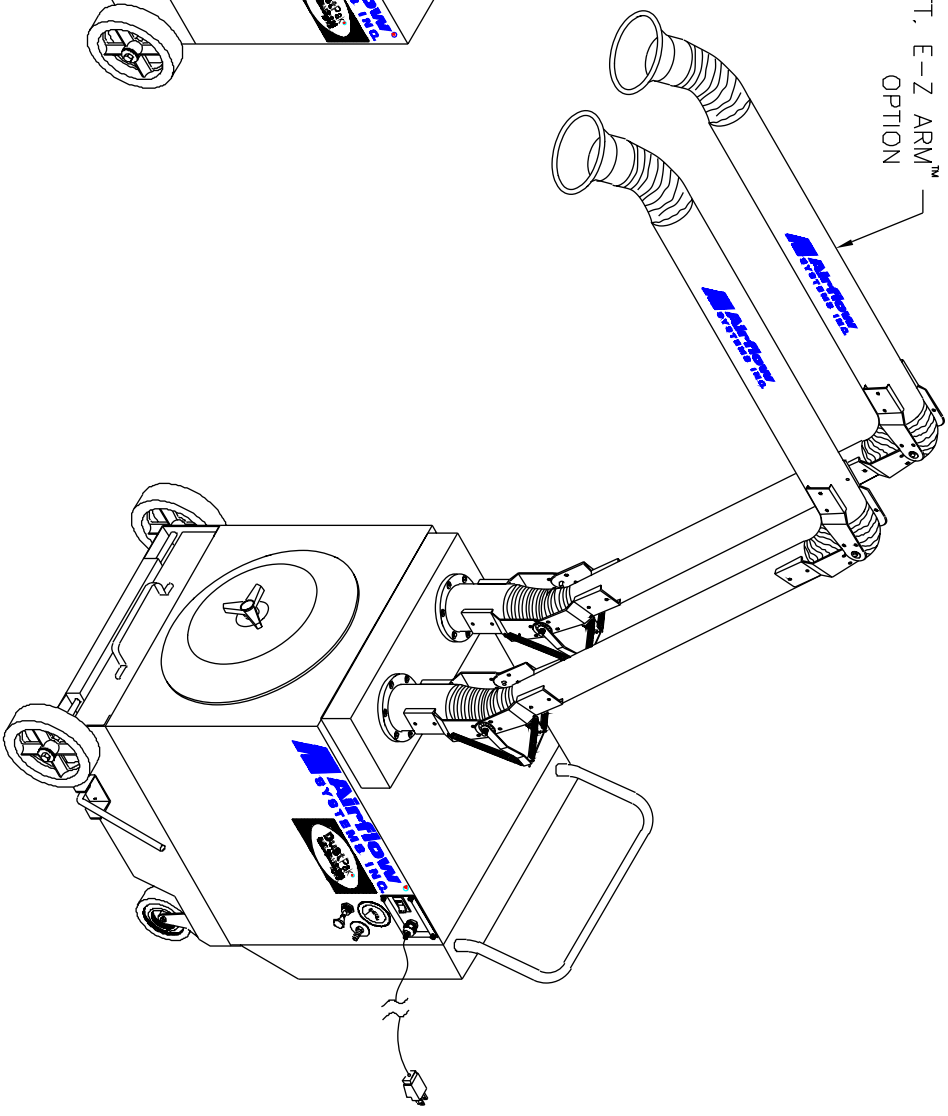

**NOTES:**

THE DEVICE DEPICTED AND DESCRIBED  
HEREON EMBODIES PROPRIETARY  
INFORMATION OWNED BY AIRFLOW SYSTEMS,  
INC. ALL DESIGN, MANUFACTURING,  
REPRODUCTION, SALES, AND PATENT RIGHTS  
REGARDING THIS DEVICE OR DRAWING ARE  
RESERVED EXCEPT WHERE EXPLICIT RIGHT  
IS GRANTED IN WRITING.

**Diversified Air Systems, Inc.**  
**Phone: 800-264-8958**

DRAWN BY PG	TITLE MODEL PCH1
DATE 10-6-00	PAGE 2 OF 2
SCALE	DRAWING NO.: PCH1SPEC (51-2877/C)