

V1 High Vacuum Filtration System



Features & Benefits

- **Dual Blower:**
2 brush type motors designed for intermittent duty.
- **Non-electrostatic operation:**
High reliability, low maintenance.
- **Over 99% efficient collection:**
Simplifies OSHA and insurance compliance.

Dimensions

Width:	16.00"
Height:	16.00"
Length:	30.00"

Options

- **Continuous-duty blower:**
Provides longer life and greater reliability.
- **HEPA High Efficiency After-Filter:**
Provides 99.97% filtration efficiency.
- **115V Electrical:**
Plugs into any standard outlet.
- **Cyclone Prefilter**
- **Portable Package:**
Includes big wheel kit, two-piece wand, and floor sweep tool.

Specifications

- **Construction:**
14/12 ga. steel cabinet, powder coated
- **Blower Pkgs:**
Dual Brush Motors
Single continuous duty motor
- **Noise Level (dBA):**
74
- **Electrical:**
Dual - 115V, 16 amps
Single - 115V, 15.6 amp
- **Nominal CFM (in.):**
200 Dual
100 Single
- **Weight (lbs.):**
77

Diversified Air Systems, Inc.
Phone: 800-264-8958
Email: info@divers-air.com
www.divers-air.com

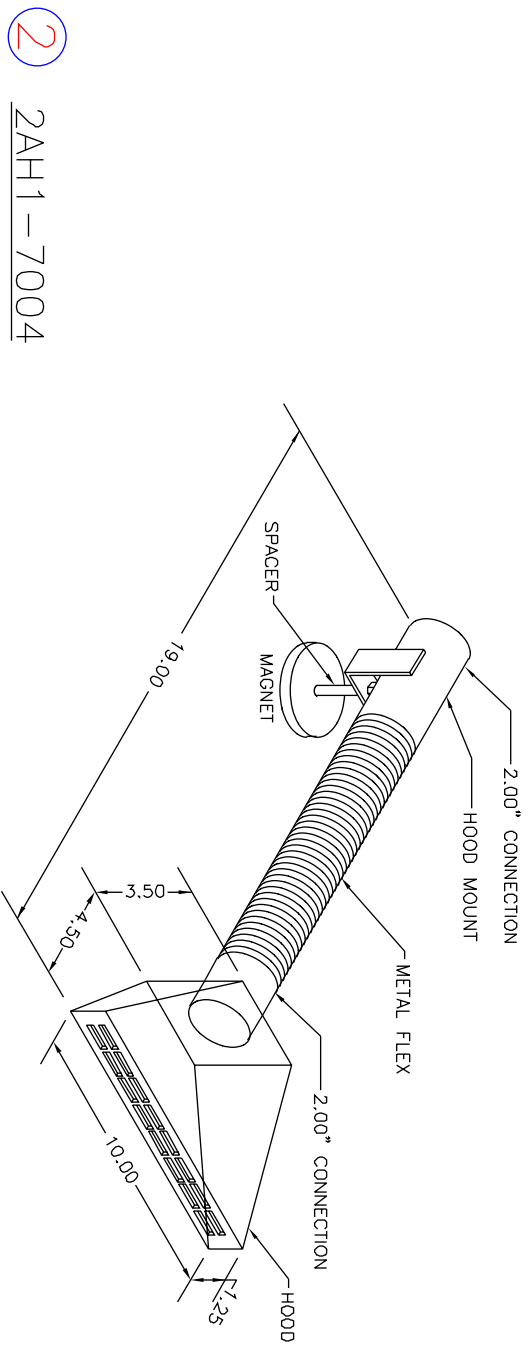

2 2AH1-7004

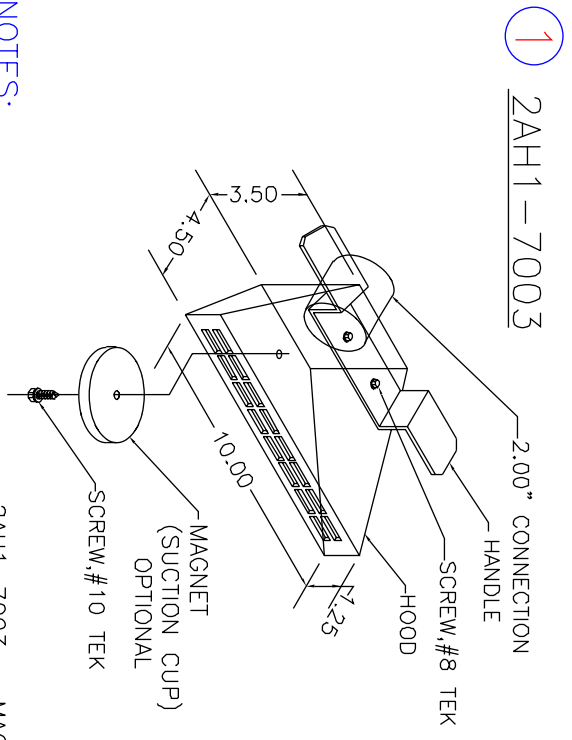

1 2AH1-7003

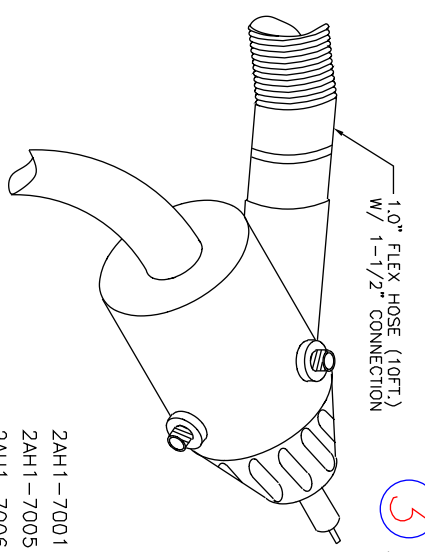

3 2AH1-7001

*FITS MOST
 250 - 400 AMP GUNS
 2AH1-7001 = 250-400 AMP GUNS
 2AH1-7005 = PUSH-PULL GUNS
 2AH1-7006 = LARGE AUTOMATICS

THE DEVICE DEPICTED AND DESCRIBED
 HEREON EMBODIES PROPRIETARY
 INFORMATION OWNED BY AIRFLOW SYSTEMS,
 INC. ALL DESIGN, MANUFACTURING,
 REPRODUCTION, SALES, AND PATENT RIGHTS
 REGARDING THIS DEVICE OR DRAWING ARE
 RESERVED EXCEPT WHERE EXPLICIT RIGHT
 IS GRANTED IN WRITING.

Diversified Air Systems, Inc.
 Phone: 800-264-8958

DRAWN BY JRS	TITLE V-1 HOOD ACCESSORIES
DATE 4-21-97	DRAWING NO.: V1HOODAC (REV A)
SCALE NTS	

NOTES:
 2AH1-7003 = MAGNET
 2AH1-7009 = SUCTION CUP

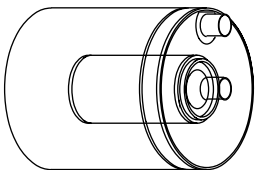

OPTIONAL
CYCLONE
PREFILTER
WITH OR
WITHOUT
INTERNAL
CARTRIDGE

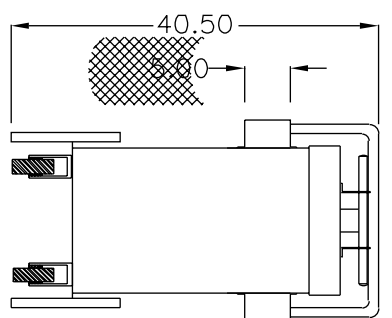
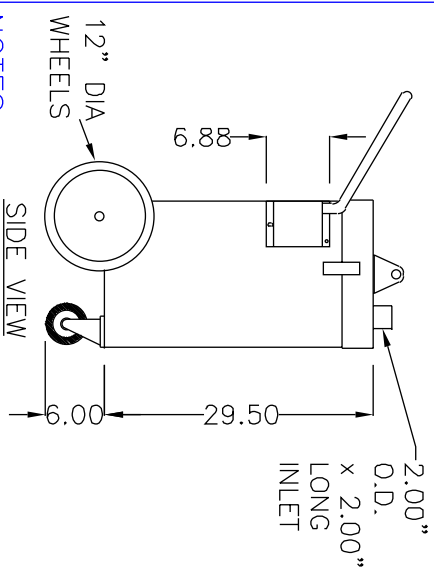
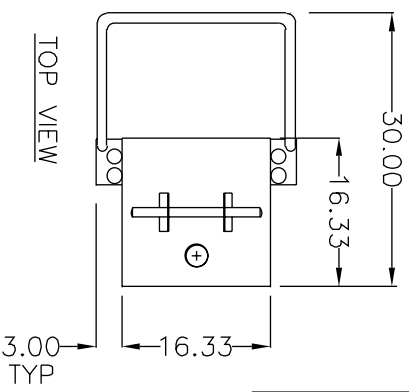

SPECIFICATIONS:

CONSTRUCTION: 18 Gauge steel cabinet finished with Powder-Cool Finish. Includes 2" inlet connection and baffled inlet chamber, inlet adapter kit, on-off switch, 6' power cord, cord wrap/handle, big wheel kit, handle, 2 piece wond, and floor sweep tool.

WEIGHT: 77 lbs.

AIRFLOW: 200 CFM max/94" W.C. max (brush motors)
107 CFM max/152" W.C. max (brushless motor)

ELECTRICAL: (2) brush-type mtr/blwrs, 115/1/60, 15.8 total amps, std.
 (2) 230/50/60, 14.0 total amps, (brush), opt.
 (1) 120/60, 15.6 amps, Continuous duty, brushless, opt.
(Not to be used in wet applications.)

NOISE: 74 dBA @ 5' (brush)
68 dBA @ 5' (brushless)

PREFILTERS: (1) Cyclone, opt.
 (1) Cyclone w/Internal cleanable/replaceable cartridge, opt.

MAIN FILTERS: (1) 95% cartridge, std.
 (1) 99.97% HEPA, opt.

OTHER OPTIONS: Smoke gun attachment
 Grinding hood kits
 Sanding hood kits
 Cyclone hanger

REPLACEMENT PARTS: Motor brushes (replace every 500 hours)

FIRE SUPPRESSION: Equipment provided by others.

* AFS FILTER EFFICIENCIES BASED ON ASHRAE 52-76 TEST METHOD

FROM SOURCE

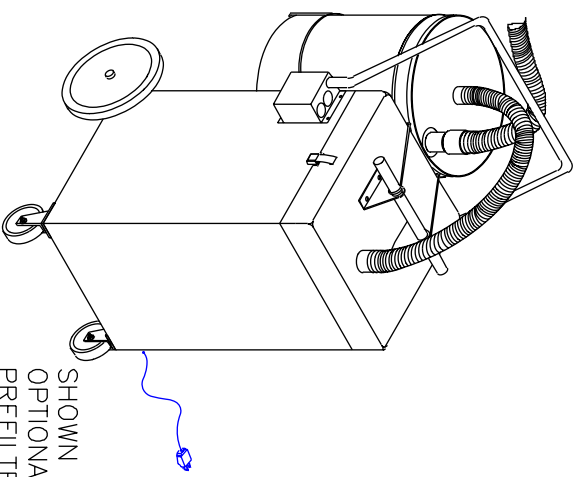

ACCESSORY HOODS

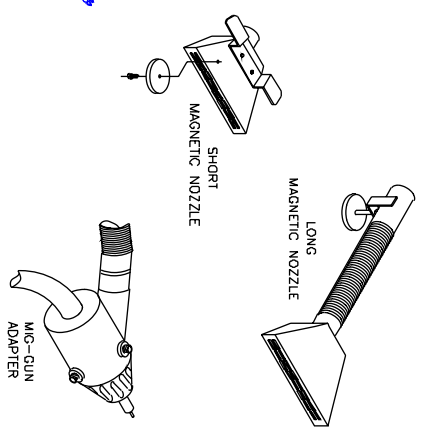

SHOWN WITH
OPTIONAL CYCLONE
PREFILTER & CYCLONE HANGER

NOTES:
Items designated as are included in this proposal

THE DEVICE DEPICTED AND DESCRIBED HEREON EMBODIES PROPRIETARY INFORMATION OWNED BY AIRFLOW SYSTEMS, INC. ALL DESIGN, MANUFACTURING, REPRODUCTION, SALES, AND PATENT RIGHTS REGARDING THIS DEVICE OR DRAWING ARE RESERVED EXCEPT WHERE EXPLICIT RIGHT IS GRANTED IN WRITING.

Diversified Air Systems, Inc.
Phone: 800-264-8958

DRAWN BY: CB
DATE: 9-26-00
SCALE:

TITLE: MODEL V1 PORTABLE
DRAWING NO.: V1PRTSPC (95-2856/G)

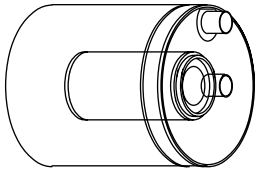

OPTIONAL CYCLONE
PREFILTER WITH OR
WITHOUT INTERNAL
CARTRIDGE

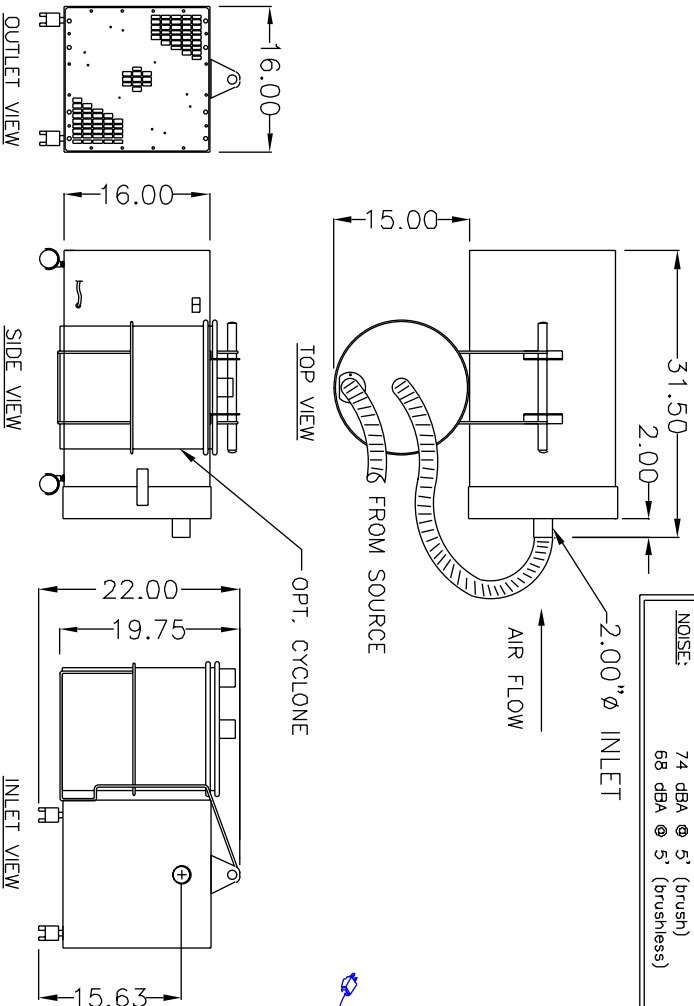

SPECIFICATIONS:

CONSTRUCTION: 18 Gauge steel cabinet finished with Powder-Cool Finish. Includes 2" inlet connection and baffled inlet chamber, inlet adapter kit, on-off switch, 6' power cord, cord wrap/handle, big wheel kit, handle, 2 piece wand, and floor sweep tool.

WEIGHT: 77 lbs.

AIRFLOW: 200 CFM max/94" W.C. max (brush motors)
107 CFM max/152" W.C. max (brushless motor)

ELECTRICAL: (2) brush-type mtr/blwrs, 115/1/60, 15.8 total amps, std.
 (2) 230/50/60, 14.0 total amps, (brush), opt.
 (1) 120/60, 15.6 amps, Continuous duty, brushless, opt.
(Not to be used in wet applications.)

NOISE: 74 dBA @ 5' (brush)
68 dBA @ 5' (brushless)

REPLACEMENT PARTS: Motor brushes (replace every 500 hours)

FIRE SUPPRESSION: Equipment provided by others.
* AFS FILTER EFFICIENCIES BASED ON ASHRAE 52-76 TEST METHOD

PREFILTERS: (1) Cyclone, opt.
 (1) Cyclone w/Internal cleanable/replaceable cartridge, opt.

MAIN FILTERS: (1) 95% cartridge, std.
 (1) 99.97% HEPA, opt.

OTHER OPTIONS: Smoke gun attachment
 Grinding hood kits
 Sanding hood kits
 Cyclone hanger

ACCESSORY HOODS

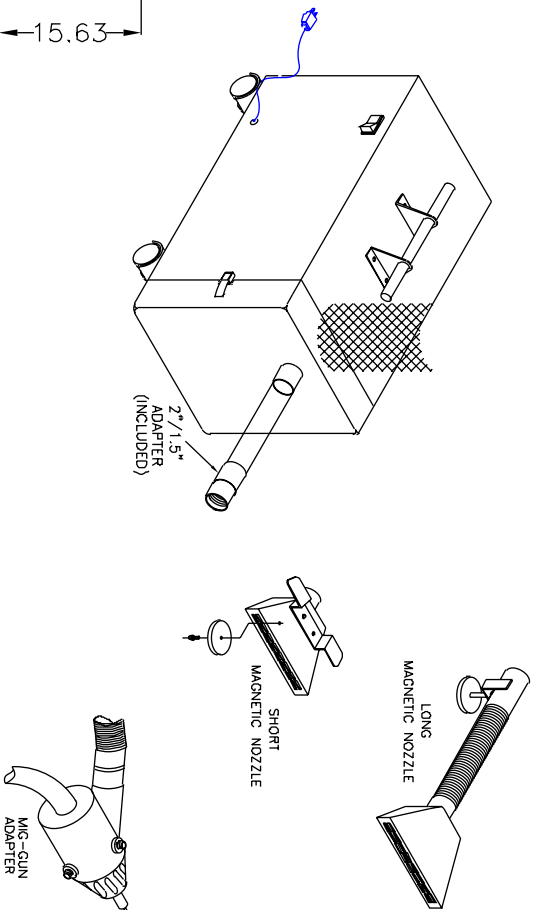

NOTES:
Items designated as are included in this proposal

THE DEVICE DEPICTED AND DESCRIBED
HEREON EMBODIES PROPRIETARY
INFORMATION OWNED BY AIRFLOW SYSTEMS,
INC. ALL DESIGN, MANUFACTURING,
REPRODUCTION, SALES, AND PATENT RIGHTS
REGARDING THIS DEVICE OR DRAWING ARE
RESERVED EXCEPT WHERE EXPLICIT RIGHT
IS GRANTED IN WRITING.

Diversified Air Systems, Inc.
Phone: 800-264-8958

Drawn by CB	TITLE MODEL V1
DATE 9-26-00	
SCALE	DRAWING NO.: V1SPEC (95-2856/G)