

Single Hose Collection Systems

Single-bay facilities often resort to opening overhead doors and running fans for relief from the annoyance of vehicle exhaust. If not controlled, vehicle exhaust can contribute to worker illness, increase facility maintenance expense, and harm the sensitive electronics of diagnostic and service equipment.

Product Overview

- Collects and removes exhaust rather than just re-circulating it within the facility.
- Easily mounts to walls or ceilings; meets virtually any facility design installation requirements.
- Boom arm extensions offer convenient hose positioning, maneuverability, and storage.

Model Shown:

Model VES-1 with 3 inch by 30 foot heavy duty exhaust hose, Balancer, and optional Oval Tailpipe Connector with Toggle Clamp and CO₂ Port.

Note:

Model VES-4, with a 4.5 inch hose system, and Model VES-6 with a 6 inch hose system are also available.



The V.E.S. Spring-Loaded Hose Balancer provides for easy handling, maneuverability, and safe equipment storage. Includes Hose Saddle and Adjustable Stop Collar.

Optional Blower Assemblies

Model No.	Product Description
VES-1 or VES-2	1.5 HP. Please specify voltage, phase and Hz.

HOSE SYSTEM SPECIFICATIONS:

WALL MOUNT:

1/2 HP: Available with choice of 3"/4.5"/6" inlets to fit hoses of some diameter; includes wall bracket, balance, and hose saddle. Choice of 1 or 3 phase motor/blower with powder coated metal parts; 115V units equipped with switch and 24 ft., 12 gauge power cord; 230/1ph and all 3 phase units utilize a motor electrical box for permanent wiring. See performance curves for operation with various hose diameters.

1.5 HP: Some as above except more powerful blower for improved performance; see performance curves below.

- HOSE OPTIONS:**
- 3" I.D. (10' increments) 30' std.
 - 4.5" I.D. (25' increments) 25' std.
 - 6" I.D. (25' increments) 25' std.

ACCESSORY OPTIONS:

- 3" Tailpipe connector w/twistlock
- 3" Oval tailpipe connector w/clamp and CO₂ port
- 4.5" Oval tailpipe connector
- 4.5" Oval tailpipe connector w/clamp and CO₂ port
- Rubber "Y" adapter, 3" x 3" x 3"
- 5" Rubber diesel stack connector
- 5" Aluminum side exhaust tailpipe connector for trucks
- Hose balancer and saddle
- Boom extension
- Starter, manual or magnetic

FIRE SUPPRESSION: Equipment provided by others.

WALL MOUNT:

YES-1 Wall mounted vehicle extraction system consisting of a 1/2 HP TEFC motor/blower 115/1/60Hz with single balance, hose saddle, 30 feet of 3 inch hose, and a 3 inch twistlock tailpipe connector.

YES-2 Wall mounted vehicle extraction system consisting of a 1/2 HP TEFC motor/blower 115/1/60Hz with a rubber "Y" adapter for dual vehicle exhaust, (2) balances, (2) hose saddles, 60 feet of 3 inch hose, and (2) 3 inch twistlock tailpipe connectors.

YES-4 Wall mounted vehicle extraction system consisting of a 1.5 HP TEFC motor/blower 115/1/60Hz with single balance, hose saddle, 25 feet of 4.5 inch hose, and a 4.5 inch oval tailpipe connector.

YES-6 Wall mounted vehicle extraction system consisting of a 1.5 HP TEFC motor/blower 115/1/60Hz with single balance, hose saddle, 25 feet of 6 inch hose, and a 5 inch rubber diesel stack connector.

ELECTRICAL:

- 1/2 HP Radial blower 115/230/1/60 *
- 1/2 HP Radial blower 208-230/460/575/3/60 *
- 1.5 HP Radial blower 115/230/1/60 *
- 1.5 HP Radial blower 208-230/460/575/3/60 *

*-(50 Hz motors available for worldwide use)

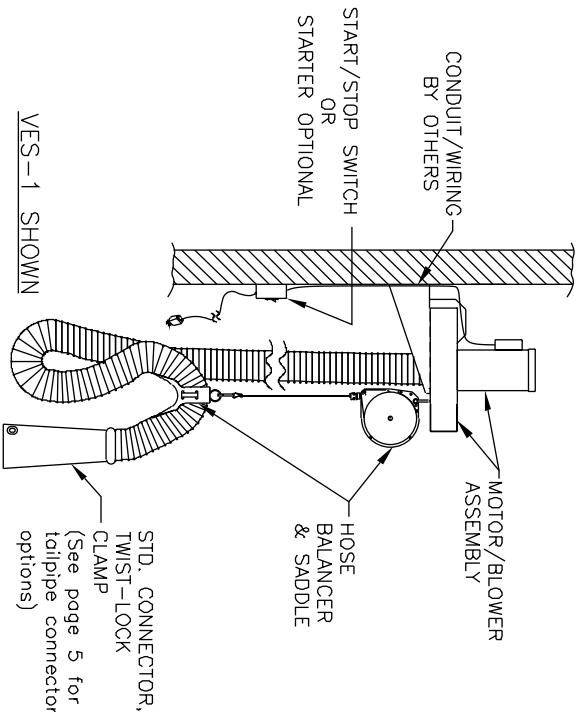

PERFORMANCE CURVES

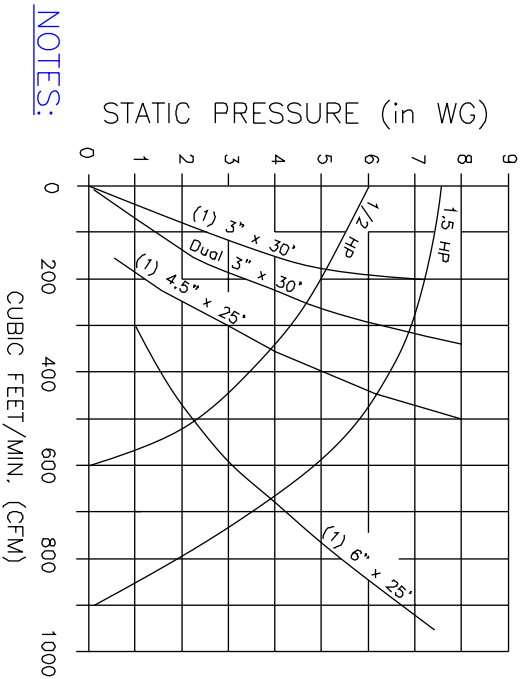

NOTES:

THE DEVICE DEPICTED AND DESCRIBED HEREON EMBODIES PROPRIETARY INFORMATION OWNED BY AIRFLOW SYSTEMS, INC. ALL DESIGN, MANUFACTURING, REPRODUCTION, SALES, AND PATENT RIGHTS REGARDING THIS DEVICE OR DRAWING ARE RESERVED EXCEPT WHERE EXPLICIT RIGHT IS GRANTED IN WRITING.

Diversified Air Systems, Inc.
Phone: 800-264-8958

DRAWN BY CB DATE 6-13-01 SCALE NTS	TITLE VES HOSE SYSTEM PAGE 2 OF 7 DRAWING NO.: VESSPEC (77-3189/B)
---	---

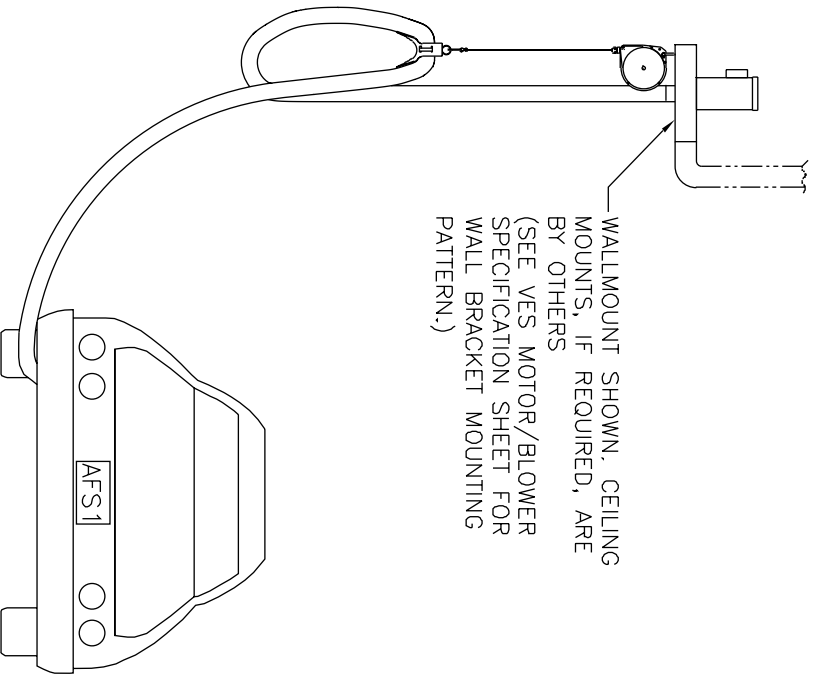

WALLMOUNT SHOWN, CEILING MOUNTS, IF REQUIRED, ARE BY OTHERS (SEE VES MOTOR/BLOWER SPECIFICATION SHEET FOR WALL BRACKET MOUNTING PATTERN.)

A: VES-1

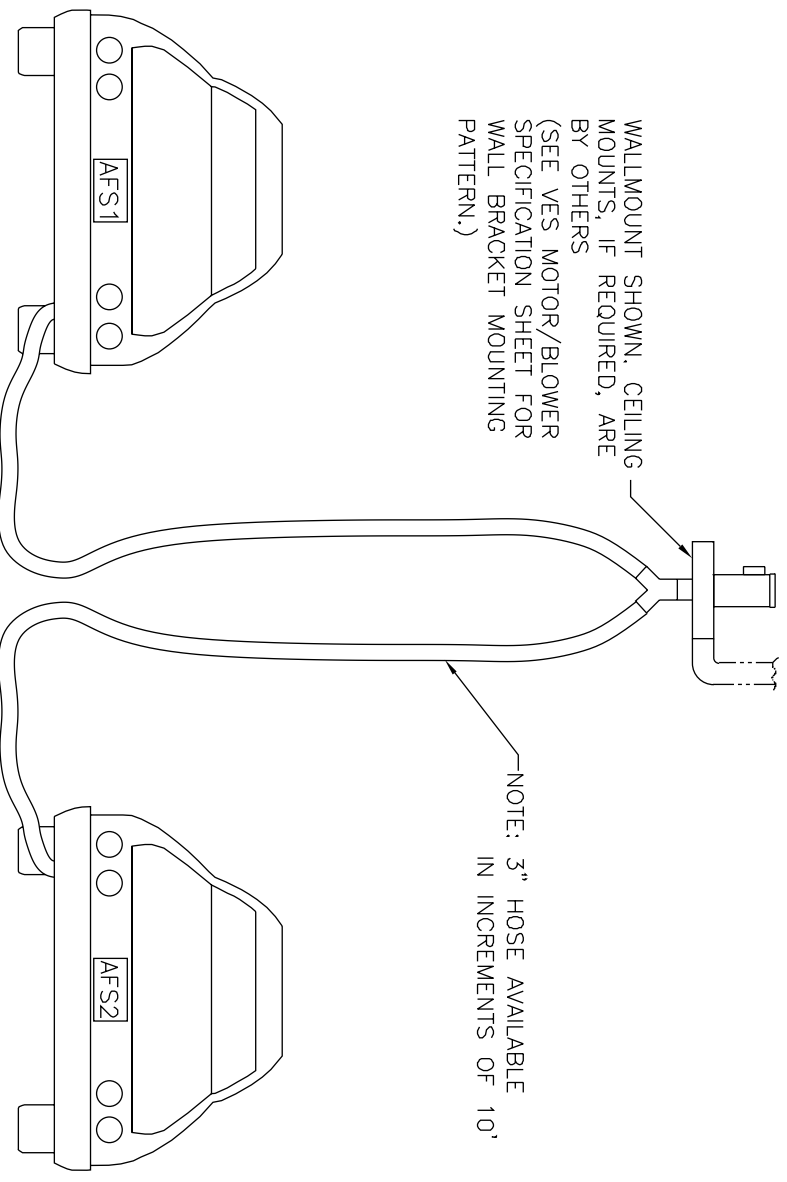

WALLMOUNT SHOWN, CEILING MOUNTS, IF REQUIRED, ARE BY OTHERS (SEE VES MOTOR/BLOWER SPECIFICATION SHEET FOR WALL BRACKET MOUNTING PATTERN.)

NOTE: 3" HOSE AVAILABLE IN INCREMENTS OF 10'

B: VES-2 (HOSE BALANCERS NOT SHOWN)

NOTES:

THE DEVICE DEPICTED AND DESCRIBED HEREON EMBODIES PROPRIETARY INFORMATION OWNED BY AIRFLOW SYSTEMS, INC. ALL DESIGN, MANUFACTURING, REPRODUCTION, SALES, AND PATENT RIGHTS REGARDING THIS DEVICE OR DRAWING ARE RESERVED EXCEPT WHERE EXPLICIT RIGHT IS GRANTED IN WRITING.

Diversified Air Systems, Inc.
Phone: 800-264-8958

DRAWN BY CB	TITLE VES HOSE ILLUSTRATIONS
DATE 6-13-01	PAGE 6 OF 7
SCALE NTS	DRAWING NO.: VESSPEC (77-3189/B)

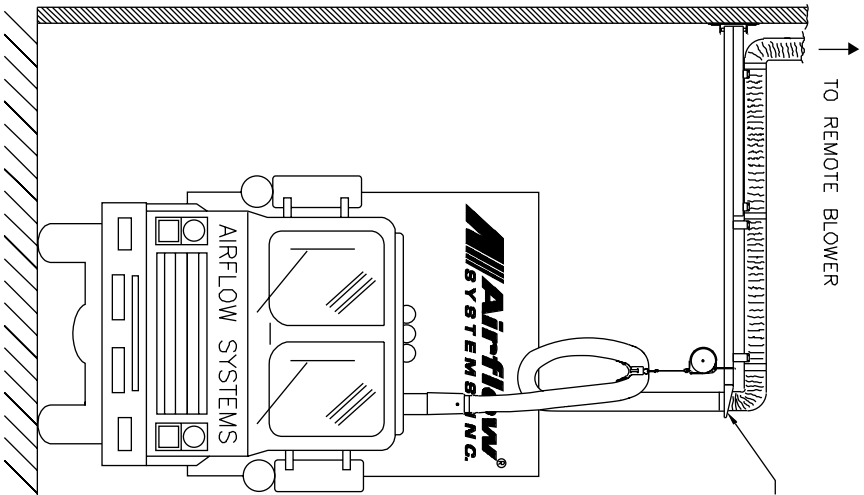

C: VES-6 MOUNTED ON 10 FOOT BOOM WITH REMOTE BLOWER (NOT SHOWN).

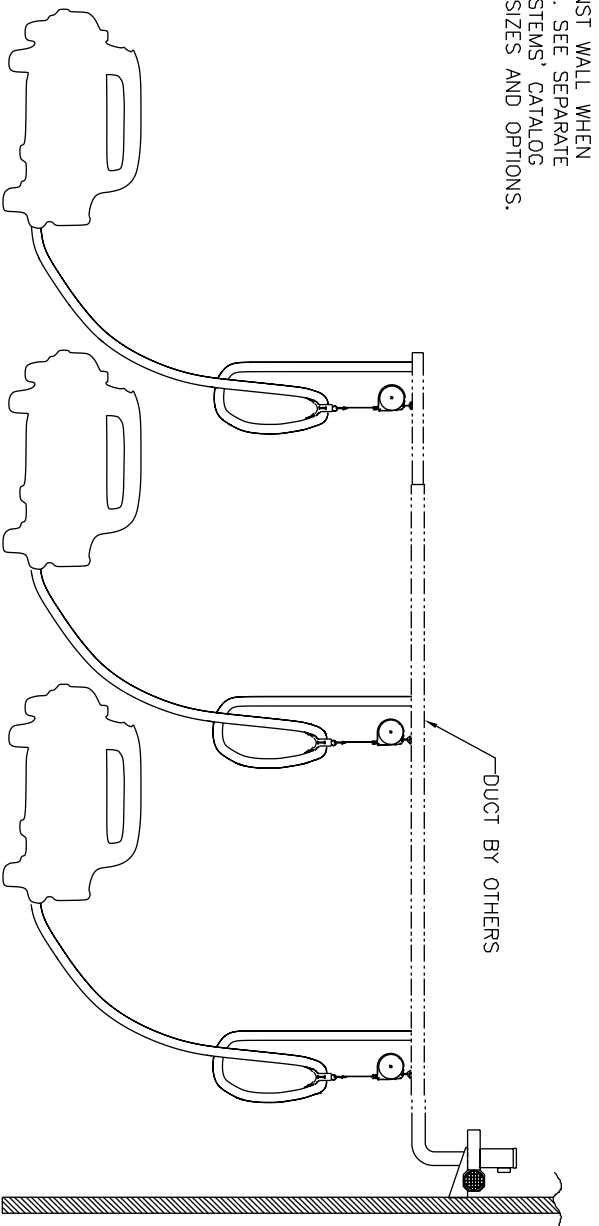

D: SINGLE BLOWER, ON CENTRAL DUCT USING 3 VES BALANCER SYSTEMS. CALL FACTORY FOR SIZING OF BLOWER.

NOTES:

THE DEVICE DEPICTED AND DESCRIBED HEREON EMBODIES PROPRIETARY INFORMATION OWNED BY AIRFLOW SYSTEMS, INC. ALL DESIGN, MANUFACTURING, REPRODUCTION, SALES, AND PATENT RIGHTS REGARDING THIS DEVICE OR DRAWING ARE RESERVED EXCEPT WHERE EXPLICIT RIGHT IS GRANTED IN WRITING.

<p>Diversified Air Systems, Inc. Phone: 800-264-8958</p>		<p>TITLE YES, CNTRL&BOOM ILLST.</p>	
<p>DRAWN BY CB</p>	<p>DATE 6-13-01</p>	<p>PAGE 7 OF 7</p>	<p>DRAWING NO.: VESSPEC (77-3189/B)</p>
<p>SCALE NTS</p>			

	A	B	C	D	E	F	G
BM05 - 1/2 HP	15.88	8.63	15.63	7.63	3.50	9.50	3.00, 4.50, OR 6.00
BM07 - 1.5 HP	18.06	9.72	18.63	9.63	4.00	11.50	

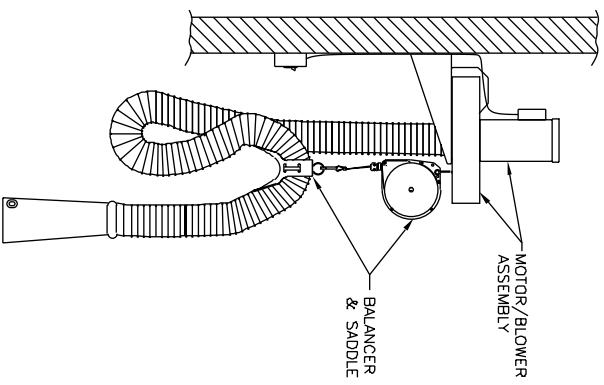
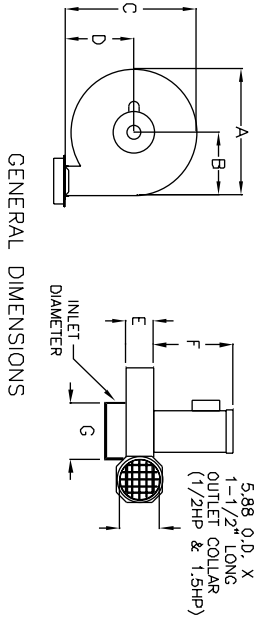

VES-1 HOSE SYSTEM
(See separate VES spec)

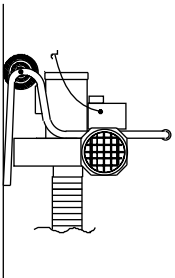

VES3-P-1/2HP
(See separate VES spec)

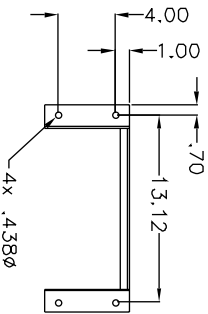

STD. WALL BRACKET
MOUNTING PATTERN (1PN77352)
1/2, 1.5, AND 3HP
(REAR VIEW)

- A = (1 EA.) 3" I.D. x 30' LONG HOSE
- B = (2 EA.) 3" I.D. x 30' LONG HOSE
- C = (1 EA.) 4.5" I.D. x 25' LONG HOSE
- D = (1 EA.) 6" I.D. x 25' LONG HOSE

1/2 HP & 1-1/2 HP MOTOR/BLOWER SPECIFICATIONS:

- BM05:** 1/2 HP, C-flange, ball bearing motor with cast aluminum wheel, self-cleaning radial blade, AMCA type B spark resistant construction.
115/1/60*, 7.4 amps
Outlet dBA: 65 dBA
- BM07:** 1.5 HP, Same as above but with more powerful blower for improved performance.
115/208-230/1/60*, 15.0/7.9-7.5 amps
208-230/460/575/3/60*, 4.8-4.2/2.1/1.7 amps
Outlet dBA: 88 dBA

*- 50 Hz available for worldwide use

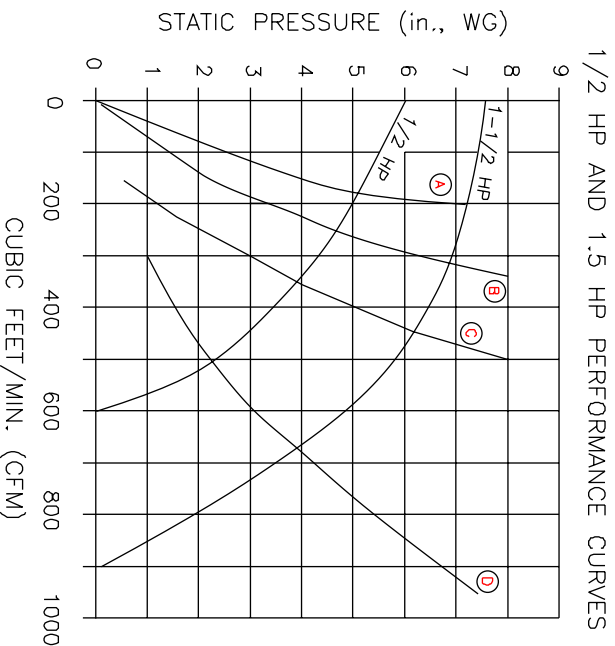

NOTES:
ITEMS DESIGNATED AS ARE INCLUDED IN THIS PROPOSAL.

THE DEVICE DEPICTED AND DESCRIBED HEREON EMBODIES PROPRIETARY INFORMATION OWNED BY AIRFLOW SYSTEMS, INC. ALL DESIGN, MANUFACTURING, REPRODUCTION, SALES, AND PATENT RIGHTS REGARDING THIS DEVICE OR DRAWING ARE RESERVED EXCEPT WHERE EXPLICIT RIGHT IS GRANTED IN WRITING.

Diversified Air Systems, Inc.
Phone: 800-264-8958

DRAWN BY: CB	TITLE: VES MOTOR/BLOWERS
DATE: 5-10-01	PAGE: 1 OF 3
SCALE: NTS	DRAWING NO.: VESBLWRS (77-3143/A)

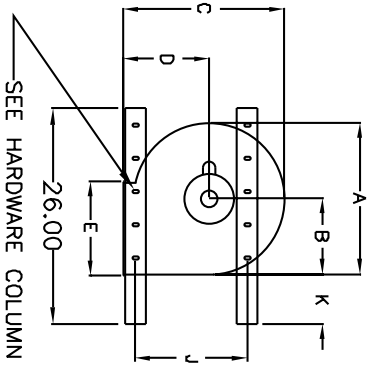

SEE HARDWARE COLUMN ON TABLE

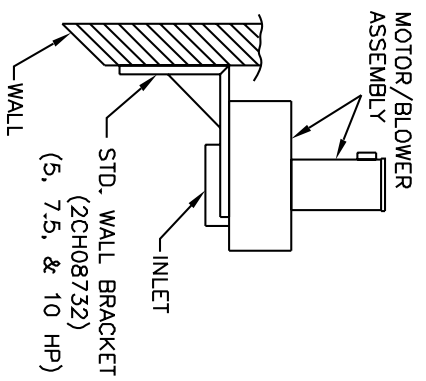
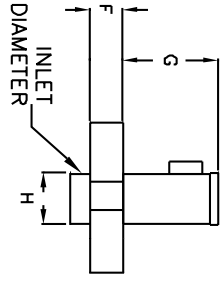

TYPICAL VIEW SEE TABLE FOR OUTLET DIMENSIONS

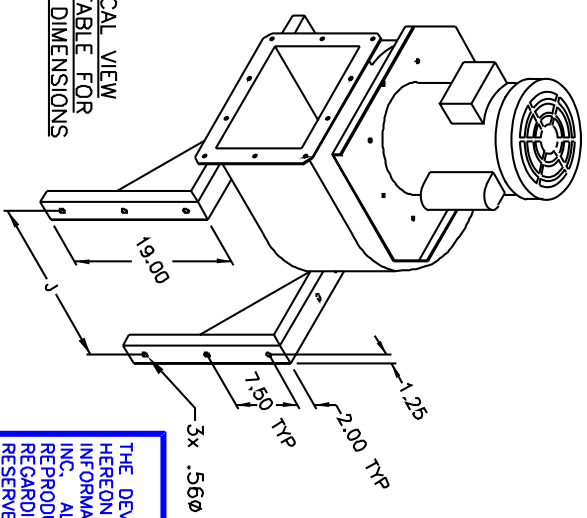

SPECIFICATIONS:

- BM12:** 3 HP C-flange ball bearing motor, 1.25 safety factor, Cast aluminum wheel, self-cleaning radial blade, AMCA type B spark resistant construction, 208-230/460/3/60, 8.0/4.0 amps
 - BM14:** 5 HP C-flange ball bearing motor, 1.25 safety factor, Cast aluminum wheel, self-cleaning radial blade, AMCA type B spark resistant construction, 208-230/460/3/60, 12.0/6.0 amps
 - BM20:** 5 HP C-flange ball bearing motor, 1.25 safety factor, Steel backward-incline wheel, 208-230/460/3/60, 12.0/6.0 amps
 - BM30:** 7.5 HP C-flange ball bearing motor, 1.25 safety factor, Steel backward-incline wheel, 208-230/460/3/60, 17.2/8.6 amps
 - BM40:** 10 HP C-flange ball bearing motor, 1.25 safety factor, Steel backward-incline wheel, high flow, 208-230/460/3/60, 24.0/12.0/9.6 amps
- NOISE:**
- 3 HP, Radial - 90 dBA / 78 dBA with silencer or duct
 - 5 HP, Radial - 95 dBA / 80 dBA with silencer or duct
 - 5 HP, B.I. - 84 dBA / 75 dBA with silencer or duct
 - 7.5 HP, B.I. - 84 dBA / 75 dBA with silencer or duct
 - 10 HP, B.I. - 89 dBA / 78 dBA with silencer or duct
- FIRE SUPPRESSION:** Equipment provided by others.
- OPTIONS:**
- Silencer mounted on outlet, (reduces noise from motor/blower)
 - 50 Hz motor

	A	B	C	D	E	F	G	H	J	K	Hard- wire	L	M	N	O	P	Q
BM12 - 3 HP RADIAL	18.00	10.50	17.00	9.00	11.50	5.06	11.25	7.88	N/A	N/A	N/A	7.18	16.38	2.41	5.46	5.00	11.44
BM14 - 5 HP RADIAL	22.25	11.50	22.75	11.00	7.31	5.75	13.75	7.88	19.00	6.00	7	12.50	16.38	6.25	5.46	9.50	13.13
BM20 - 5 HP B.I.	23.25	13.25	22.00	10.50	13.38	9.75	13.75	11.88	19.00	6.00	7	12.50	16.38	6.25	5.46	9.50	13.13
BM30 - 7.5 HP B.I.	25.50	14.50	24.00	11.38	14.63	10.75	15.50	13.88	20.00	6.00	8	12.50	16.38	6.25	5.46	10.31	14.25
BM40 - 10 HP B.I.	28.50	15.81	27.88	12.00	16.75	11.38	14.50	15.88	22.50	6.00	8	13.00	20.25	6.50	6.75	11.00	16.31

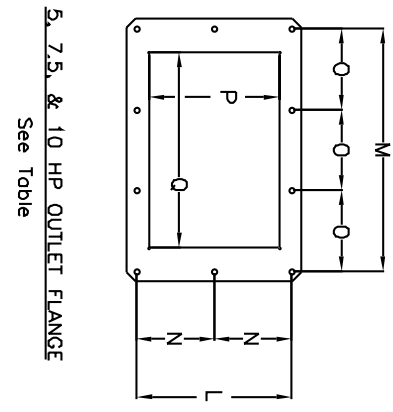
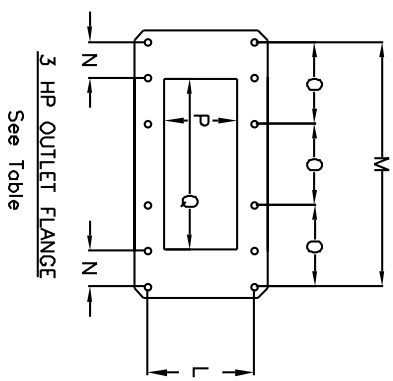

THE DEVICE DEPICTED AND DESCRIBED HEREON EMBODIES PROPRIETARY INFORMATION OWNED BY AIRFLOW SYSTEMS, INC. ALL DESIGN, MANUFACTURING, REPRODUCTION, SALES, AND PATENT RIGHTS REGARDING THIS DEVICE OR DRAWING ARE RESERVED EXCEPT WHERE EXPLICIT RIGHT IS GRANTED IN WRITING.

Diversified Air Systems, Inc.
Phone: 800-264-8958

DRAWN BY: CB
DATE: 6-10-01
SCALE: NTS
TITLE: YES MOTOR/BLOWERS
PAGE 2 OF 3
DRAWING NO.: VESBLWRS (77-3143/A)

NOTES: