

Vehicle Exhaust Systems Accessories

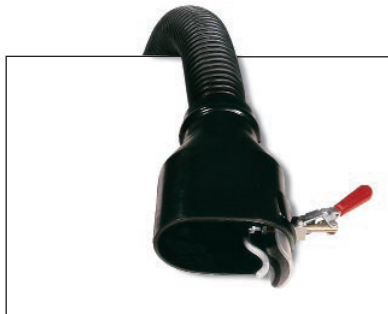

Part No. 7TLO-9010

3 inch Standard Tailpipe Connector with twistlock for 3 inch hose.



Part No. 2TLO-9005

3 inch Optional Oval Tailpipe Connector with Toggle Clamp and CO₂ Port.



Part No. 7TLO-9019

4.5 inch Standard Oval Tailpipe Connector.

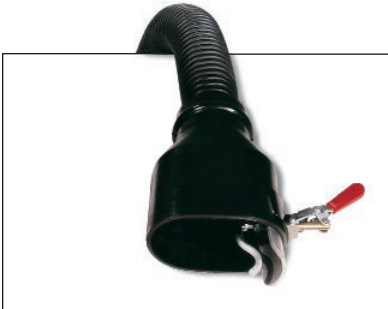

Part No. 2TLO-9009

4.5 inch Optional Oval Tailpipe Connector with Toggle Clamp and CO₂ port.



Part No. 7TLO-9006

3 inch by 3 inch by 3 inch Rubber "Y" Adapter. Snaps inside 3 inch hose.



Part No. 7TLO-9007

6 inch Rubber Diesel Stack Connector.



Part No. 2TLO-9012 (4.5")

5 inch Aluminum Tailpipe Connector for Trucks — side exhaust. Connects to 4.5 inch hose.



Part No. 2BL7-7306

Hose Balancer made of powder coated steel secured by 1/2 inch bolts. 1-1/4 inch diameter steel pipe adds rigidity. Outer drum constructed of 16 gauge steel.

Optional Remote Mounted Blowers For Central Systems (Remote Mounted Blowers not shown)

Model No.	Product Description
3 HP	3 HP Motor/Blower assembly with mounting stand
5 HP	5 HP Motor/Blower assembly with mounting stand
7.5 HP	7.5 HP Motor/Blower assembly with mounting stand
10 HP	10 HP Motor/Blower assembly with mounting stand

ACCESSORIES

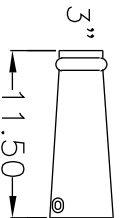

STANDARD TAILPIPE CONNECTOR 3"Ø;
Snaps over cuffed end of 3" hose (7TL0-9010)

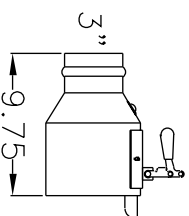

3"Ø OVAL TAILPIPE CONNECTOR WITH TOGGLE CLAMP AND CO2 PORT
Fits over cuffed end of 3" hose (2TL0-9005)

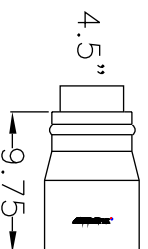

4.5"Ø OVAL TAILPIPE CONNECTOR
Includes swivel transition to 4.5" hose and 4.5" hose clamp (2TL0-9019)

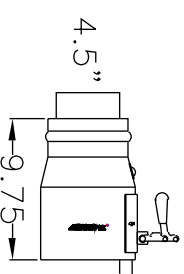

4.5"Ø OVAL TAILPIPE CONNECTOR WITH TOGGLE CLAMP AND CO2 PORT
Includes swivel transition to 4.5" hose and 4.5" hose clamp (2TL0-9009)

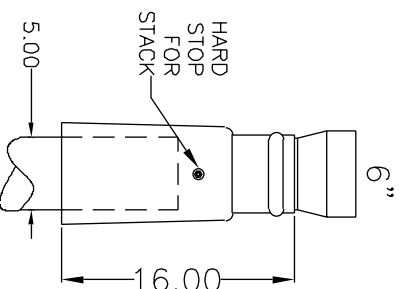

5" RUBBER DIESEL STACK CONNECTOR
Includes swivel transition to 6" hose and 6" hose clamp (2TL0-9007)

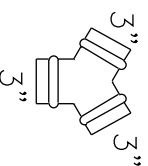

RUBBER "Y" ADAPTER
3"Ø X 3
Snaps inside AFS 3" hose, allows (1) blower to service (2) autos (7TL0-9006)

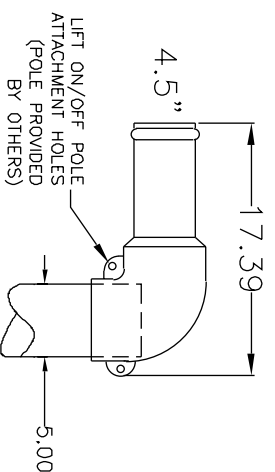

5" ALUM. TAILPIPE CONNECTOR FOR TRUCKS
Fits inside 4.5" hose and includes a 4.5" hose clamp (2TL0-9012)

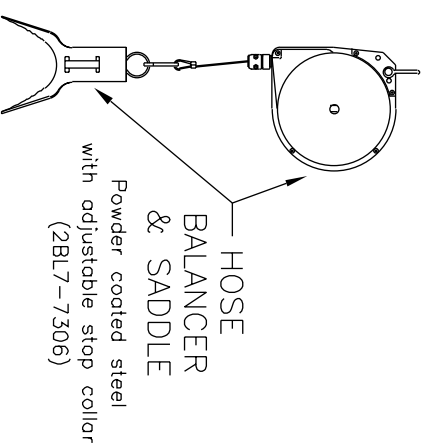

HOSE BALANCER & SADDLE
Powder coated steel with adjustable stop collar (2BL7-7306)

THE DEVICE DEPICTED AND DESCRIBED HEREON EMBODIES PROPRIETARY INFORMATION OWNED BY AIRFLOW SYSTEMS, INC. ALL DESIGN, MANUFACTURING, REPRODUCTION, SALES, AND PATENT RIGHTS REGARDING THIS DEVICE OR DRAWING ARE RESERVED EXCEPT WHERE EXPLICIT RIGHT IS GRANTED IN WRITING.

Diversified Air Systems, Inc.
Phone: 800-264-8958

DRAWN BY CB	TITLE VES. NOZZLES
DATE 6-13-01	PAGE 5 OF 7
SCALE NTS	DRAWING NO.: VESSPEC (77-3189/B)

NOTES: